

Hygienic Windows

Seamless Flush Windows, Non Fire Rated. Steel or FRP Frames



LEADING EDGE TECHNOLOGY FOR SUPERIOR HYGIENE PERFORMANCE

Dortek windows are specially constructed to offer superior quality and to reinforce hygiene in all environments where infection control is critical. Manufactured to suit both traditionally built and modular wall systems, the Dortek cleanroom window complies with GMP/GLP requirements.

Windows are mounted into the wall system to provide a completely flush surface without ledges or joints. Insulated glass units or double flush glazing can be easily incorporated into most designs.

We are market specialists; with over 45 years experience in providing high performance solutions to the worlds leading pharmaceutical, food and healthcare companies. We take responsibility for the overall planning and coordination of projects in order to deliver a complete solution.

As a leading single source supplier, we can satisfy diverse customer needs, offering you the benefits of our extensive manufacturing capability, technical expertise and innovative product solutions.

ULTRA FLUSH

Fully sealed seamless surface for a smooth attractive finish which is easy to keep clean. Free from corners, ledges and gaps where particles and germs can accumulate.

SUPREME QUALITY

Engineered to offer supreme visibility, quality and hygiene in the most demanding environments. These windows will not rot, rust, condense or corrode. Designed to meet ISO and GMP requirements.

100% WATER & CHEMICAL PROOF

Unaffected from exposure to water, steam, disinfectants, chlorine and strong chemicals even after decades of use.

SMARTGLASS TECHNOLOGY

Through the use of liquid crystal technology, we can offer smart glass windows which change from transparent to opaque in just one switch. Allowing total privacy without the need for blinds, curtains or shutters.

INTEGRATED BLINDS

Alternatively, we also offer windows with integrated blinds. The blinds are fixed between two panels of glass to prevent the build up of dust, dirt or bacteria.

LEAD LINING

Windows can incorporate x-ray shielding for varying lead thicknesses depending on the required specification.

TURNKEY SOLUTIONS

Dortek provides complete solutions which are individually crafted to meet your specification. We offer a wide range of windows, transfer hatches, doors, frames, hardware, vision panels, access controls, automations and interlocking.

*Terms and Conditions apply: contact us for details

TECHNICAL FEATURES

CONSTRUCTION

Clear 0.23 inch (6mm) toughened glass.
0.98 inch (25mm) border surround to the glazing. Single or double glazed option available for a flush surface on both sides of the wall containing the window.

SIZES

Available in customizable sizes to suit clients' requirements.

FRAMES

- Available in 2 frame types: FRP or Stainless Steel with no fixings or screws to maximise hygiene.

FINISH

- Easy to clean, low maintenance, smooth, flush surface with a choice of colors for FRP frames.
- Designed to withstand all typical cleaning methods.

OPTIONS

- Integral blinds
- Smartglass
- Lead lining or laser protection.

Hygienic Windows

Architectural Details

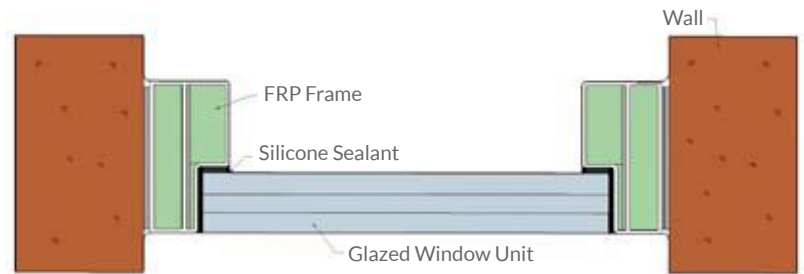

FRP Framed Window

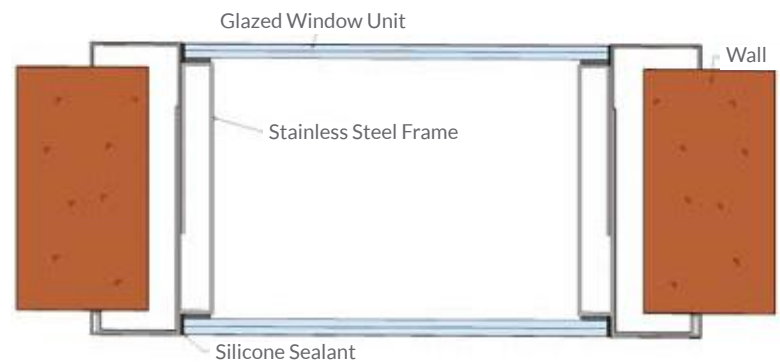

Stainless Steel Framed Window



Sealed Flush Finish



Integral Blinds



Stainless Steel Frame

Dortek Inc
10 East 6th Avenue
Suite 310
Conshohocken
Pennsylvania 19428
Tel: +1 617 401 8226
Email: us-sales@dortek.com

Dortek Limited, UK
St Mark Street
Hull, HU8 7ED
England
Tel: +44 (0) 1482 226848
Fax: +44 (0) 1482 226843
Email: info@dortek.com

Dortek Limited, Ireland
North Quay, Wicklow Town
County Wicklow, A67 HE26
Ireland
Tel: +353 (0) 404 67101
Fax: +353 (0) 404 67012
Email: ireland@dortek.com

Dortek, Singapore
Dortek Hygienic Door Systems Pte Ltd
627A Aljunied Road
BizTech Centre 04-06
Singapore
389842
Tel: +65 67411787
Email: info@dortek.com